

Horizontal Reaction, P2 = 155 lbs
 Horizontal Reaction increased to 395 lbs
 w/ (1) #10 sds installed into return lip
 Kwik Bolt 3 limited to 310 lbs

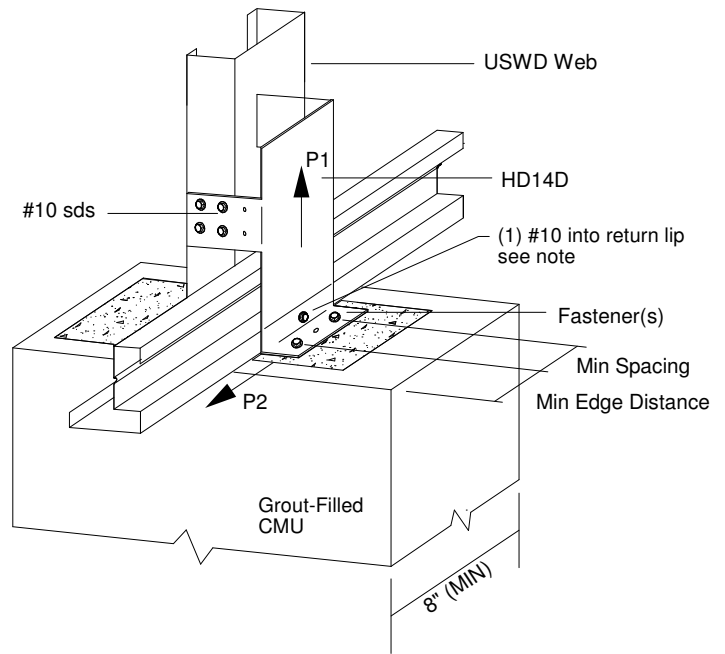

MAXIMUM CAPACITY (LBS)

	FASTENER	#	EDGE DIST. (IN)	SPAC (IN)	EMBED (IN)	#10 SDS TAB	UPLIFT P1
1224HD14D	3/8" HIT HY 150 MAX	1	4	NA	3.375	4	1100
	1/2" HIT HY 150 MAX	1	4	NA	4.5	4	1319
	Kwik Bolt 3 1/2" Dia.	1	1.75	NA	3	2	645
	Kwik Bolt 3 5/8" Dia.	1	1.75	NA	3.5	2	850
	HUS-H 1/2" Dia	1	2.75	NA	3	2	745
	HUS-H 5/8" Dia	1	2.75	NA	4	4	1175
1226HD14D	X-U	2	2.75	2.75	1	2	330
	1/2" HIT HY 150 MAX	1	4	NA	4.5	4	1319
	5/8" HIT HY 150 MAX	1	4	NA	5.625	4	1450

- 1) Min. screw spacing & edge distance = 9/16".
- 2) Min. bearing width = 8".
- 3) Place fasteners in line w/ holes in the HD14D.
- 4) HD product specified is manufactured by Aegis Metal Framing. Any substitution is prohibited.
- 5) Equivalent fasteners may be substituted.
- 6) Minimum Grout f'c = 1500 psi
- 7) When this connection detail is applied to both plies of a 2-ply truss, the capacities double.
- 8) This detail does not indicate or imply that the depicted bearing is structurally adequate for the loads shown. Design of bearing is req'd.
- 9) Max. Reactions shown are non-concurrent.

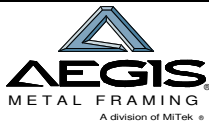

www.AegisMetalFraming.com

14515 N. Outer 40 Drive - Suite 110
 Chesterfield, MO 63017

Phone: (866) 902-3447 Fax: (314) 434-5234

TRUSS TO TRUSS CONNECTION
 USKW w/ USGP

DETAIL NO.

D-CMU-2

CATEGORY

STANDARD DETAILS

DATE

3/2012