

MAXIMUM CAPACITY (LBS) - UNCRACKED CONCRETE

	FASTENER DIA. X EMBED.	MIN. CONC. (PSI)	MIN. EDGE DIST. (IN)	MIN. CONC. DEPTH (IN)	#10 HD-W or HD-B	UPLIFT P1	HORIZ P2	MIN WEB
423HD16	KWIK HUS (KH) 3/8" X 2-1/2"	3000	2	4	3	650	485	035 USW
		4000	1.75					
	KWIK BOLT 3 3/8" X 2"	3000	2.25	4	3	650 (1280)	485	
		4000	2					
423HD14	KWIK HUS (KH) 3/8" X 2-1/2"	3000	3	4	5	1210 (2300)	485	
		4000	2.5					
	KWIK BOLT 3 3/8" X 2"	3000	3.75	5	5	1400 (2470)	485	
		4000	3.25					
423HD12	KWIK HUS (KH) 3/8" X 3-1/4"	3000	3.25	5	5	1400 (2470)	485	
		4000	2.75					
	KWIK BOLT 3 3/8" X 2"	3000	4	5	5	1400 (2470)	485	
		4000	3.25					
426HD14	KWIK HUS (KH) 1/2" X 3"	3000	4	5	4	1630	795	046 USW
		4000	3.25					
	KWIK BOLT 3 1/2" X 3-1/4"	3000	4	6	4	1630 (2595)	795	
		4000	3.5					
(2) HIT HY 150 MAX+ HAS 3/8" X 3" 1	3/8" X 3-1/4" 1	3000	2.5	6	5	2105 (3325)	795 (1435)	
		4000	2.5					
(2) KWIK HUS (KH) 3/8" X 3-1/4" 1	3/8" X 3-1/4" 1	3000	3.25	5	5	2105 (3815)	795	
		4000	2.75					
426HD12	KWIK HUS (KH) 1/2" X 4-1/4"	3000	4.25	6	5	2270 (3605)	1105	057 USW
		4000	3.75					
	HIT HY 150 MAX+ HAS 1/2" X 2-3/4"	1/2" X 2-3/4"	3000	4.25	6	5	2270 (3655)	1105
			4000	3.5				
(2) HIT HY 150 MAX+ HAS 3/8" X 3" 1	3/8" X 3" 1	3000	4	5	6	2955 (3730)	1560 (2255)	DOUBLE 046 USW
		4000	3.5					
(2) KWIK HUS (KH) 1/2" X 4-1/4" 1	1/2" X 4-1/4" 1	3000	4	6.75	6	2955 (4650)	1560 (2690)	
		4000	3.5					

1 Two fastener spacing = 3" centered on clip

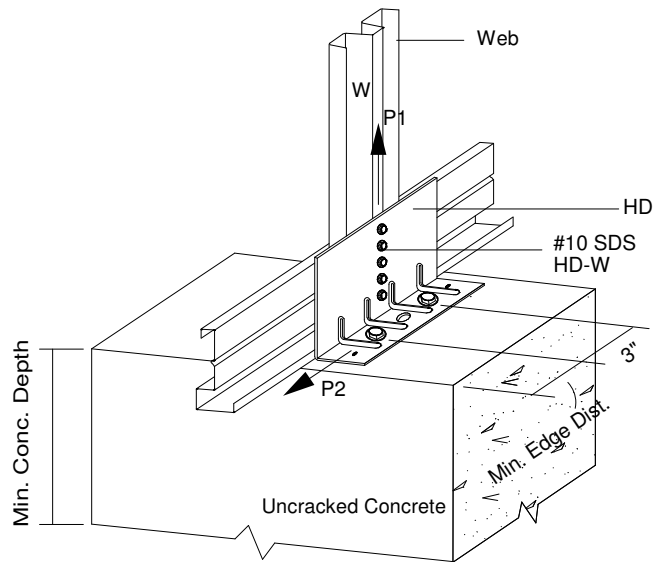
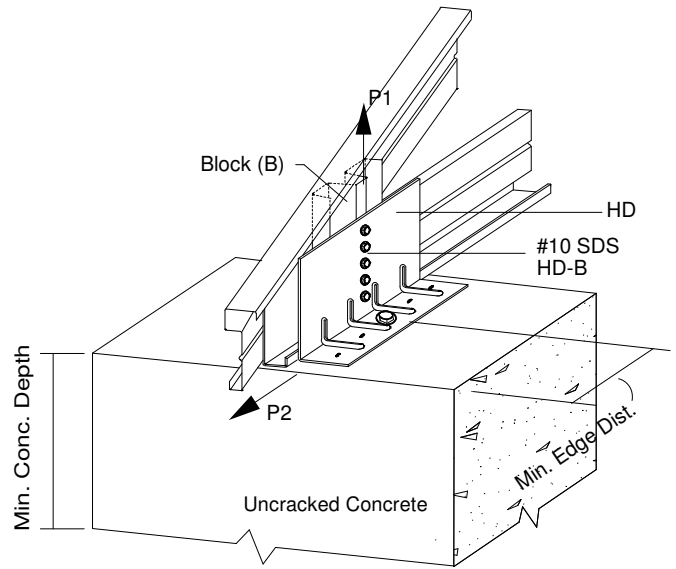

- 1) Min. screw spacing & edge distance = 9/16".
- 2) Refer to the Hilti Product Technical Guide for installation requirements and application limits.
- 3) HD product specified is manufactured by Aegis Metal Framing. Any substitution is prohibited.
- 4) Single fastener to be placed in center hole in HD.
- 5) This detail does not indicate or imply that the depicted bearing is structurally adequate for the loads shown. Design of bearing is req'd.
- 6) For 2-ply trusses reactions may be doubled unless otherwise noted in parenthesis.
- 7) Max Reactions shown are non-concurrent
- 8) Designed in accordance with ACI 318-08 App. D



www.AegisMetalFraming.com
14515 N. Outer 40 Drive - Suite 110
Chesterfield, MO 63017
Phone: (866) 902-3447 Fax: (314) 434-5234

USC TRUSS TO CONCRETE BEARING
423/426HD

Revised 8/2012 - New clips, concrete standard, screw values

DETAIL NO.

C-CON-1.1

CATEGORY

STANDARD DETAILS

DATE

8/2012