

| Allowable Tie-in Truss Reaction/Uplift (lbs) | | | | |
|--|------|------------|------|-----------------------|
| USC Girder | | | | |
| Tie-in | USKW | #10 screws | | Reaction/Uplift (lbs) |
| | | A | B | |
| USC | 35 | 4 | 4 | 970 |
| | | 5 | 5 | 1215 |
| | 55 | 6 | 6 | 1455 |
| 8 | | 8 | 1940 | |
| USD | 35 | 2 | 4 | 340 |
| | | 3 | 6 | 510 |
| | | 3 | 8 | 640 |
| | | 4 | 10 | 850 |
| | 55 | 4 | 8 | 890 |
| | | 5 | 10 | 1110 |
| | | 6 | 12 | 1335 |
| 7 | 14 | 1560 | | |

| Allowable Tie-in Truss Reaction/Uplift (lbs) | | | | | |
|--|------|------------|------|------|-----------------------|
| USD Girder | | | | | |
| Tie-in | USKW | #10 screws | | | Reaction/Uplift (lbs) |
| | | A | B | C | |
| USC | 35 | 2 | 2 | 4 | 970 |
| | | 3 | 3 | 6 | 1215 |
| | 55 | 3 | 3 | 6 | 1455 |
| 4 | | 4 | 8 | 1940 | |
| USD | 35 | 5 | 5 | 10 | 2370 |
| | | 2 | 2 | 4 | 340 |
| | | 3 | 3 | 6 | 510 |
| | | 4 | 4 | 8 | 640 |
| | 55 | 5 | 5 | 10 | 850 |
| | | 4 | 4 | 8 | 890 |
| | | 5 | 5 | 10 | 1110 |
| 6 | 6 | 12 | 1335 | | |
| 7 | 7 | 14 | 1560 | | |

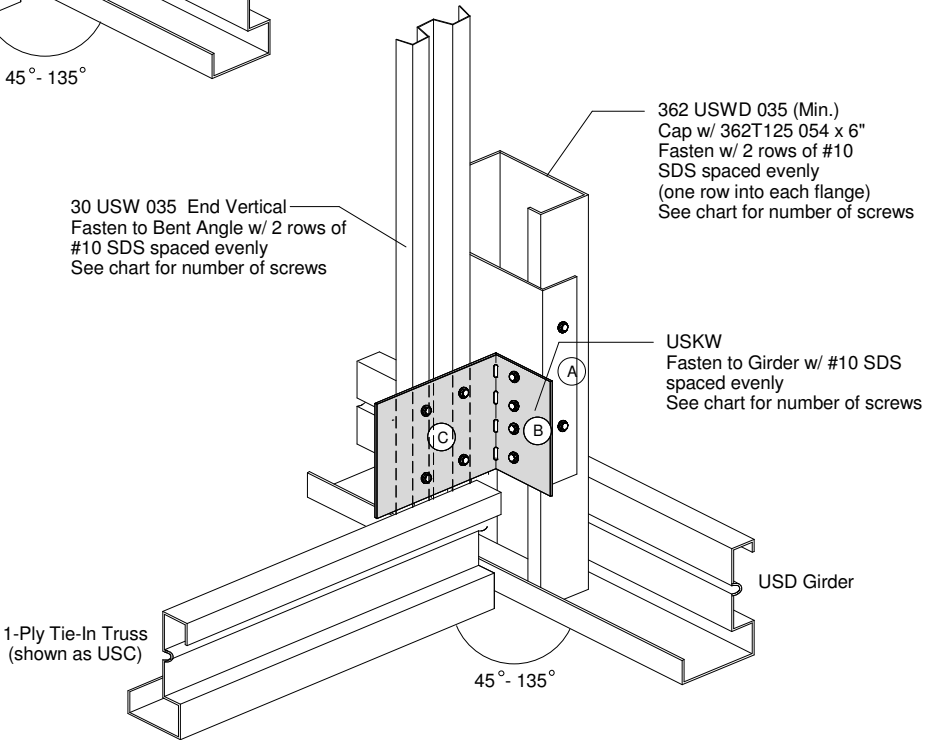

Notes
 1. Minimum screw spacing & edge distance = 9/16"

METAL FRAMING a division of MITEK®
 www.AEGISMETALFRAMING.COM
 14515 N. Outer 40 Drive Suite 110
 Chesterfield, MO 63017
 Phone:866/902-3447 Fax:314/434-5234

TRUSS-TO-TRUSS CONNECTION
 1-PLY TIE-IN TO GIRDER W/ USKW

DETAIL NO.
US2US-21

CATEGORY
 STANDARD DETAILS

DATE
 8/21/2008